



City of Margate, Florida  
Building Department

## MINIMUM PERMIT REQUIREMENTS

FOR

## UTILITY SHEDS

- PERMIT APPLICATION COMPLETELY FILLED OUT SIGNED AND NOTARIZED
- HOMEOWNER'S AFFIDAVIT (when obtaining an Owner/Builder Permit)

### THE FOLLOWING DOCUMENTS MUST BE SUBMITTED IN DUPLICATE

- NOTICE OF COMMENCEMENT OVER \$ 2,500.00 IN VALUE
- CURRENT SURVEY SHOWING ALL EASEMENTS AND ELEVATIONS
- NOTICE OF ACCEPTANCE (NOA) FOR PREFABRICATED SHED  
(Prefabricated Sheds must be approved by the Department of Community Affairs or Dade County Approved. A label showing the approval must be attached to the Shed.)
- ARCHITECTURAL PLANS PREPARED BY AN ARCHITECT OR ENGINEER  
(All Sheds constructed on site require Two (2) sets of plans, designed, signed and sealed, by a Professional Engineer or Architect)
- SITE PLAN SHOWING LOCATION OF SHED
- FOUNDATION SLAB DRAWINGS

#### **Zoning Requirements**

Contact the City of Margate Zoning Department  
For Current Set Back & Height Requirements  
954-972-0828

**THE PERMIT APPLICATION WILL NOT BE ACCEPTED WITHOUT THE ABOVE MINIMUM DOCUMENTATION**

**OTHER DOCUMENTS MAY BE REQUIRED DEPENDING UPON THE JOB CONDITIONS**

City of Margate, Florida  
Building Department

**SWIMMING POOL, PATIOS AND SHED SLAB REQUIREMENTS**

Florida Building Code Section R 4404.3.5 Discontinuous Edges.

The discontinuous edges of all concrete slabs surrounding a Swimming Pool, Screened Patios, Patios, and Sheds shall be a minimum of 8" deep by 8" wide and shall be reinforced with 1 continuous # 5 rebar. The Slab shall be reinforced with 6" x 6" # 10 wire in the middle of the slab.

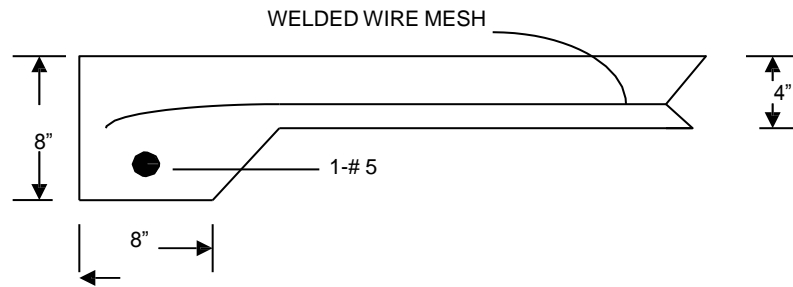

**Mandatory Inspections**

An inspection must be requested and passed prior to pouring of concrete.  
After completion of work and surrounding areas are repaired a Final Inspection must be requested and approved.

**DRIVEWAYS**

**Minimum Requirements**

Minimum four inches (4") thick  
Expansion joint required at existing concrete.  
Cut control joints at 20' on center maximum  
Fiber mesh is not approved unless product approval is submitted and approved with permit.

**Mandatory Inspections**

An inspection must be requested and passed prior to pouring of concrete.  
After completion of work and surrounding areas are repaired a Final Inspection must be requested and approved.



City of Margate, Florida  
 Building Department

DURING A HURRICANE WATCH  
 & BEFORE THE ONSET OF HURRICANE VELOCITY WINDS  
 YOU ARE REQUIRED TO

# SECURE THIS JOB

IN ACCORDANCE WITH THE BROWARD COUNTY ADMINISTRATIVE PROVISIONS  
 OF THE FLORIDA BUILDING CODE SECTION 109.12

**All loose objects  
 In exposed outdoor locations  
 shall be lashed to rigid construction  
 or shall be stored in buildings.**

Florida Building Code Broward County Administrative Provisions  
 Section 109.12.2.4

NOTICES ISSUED BY THE NATIONAL WEATHER SERVICE OF A HURRICANE WATCH ARE  
 DEEMED SUFFICIENT NOTICE TO THE OWNER OF REAL PROPERTY UPON WHICH  
 CONSTRUCTION IS OCCURRING, OR ANY CONTRACTOR RESPONSIBLE FOR SAID  
 CONSTRUCTION, TO SECURE LOOSE CONSTRUCTION DEBRIS AND LOOSE CONSTRUCTION  
 MATERIALS AGAINST EFFECTS OF HURRICANE FORCE WINDS

**This includes but not limited to:**

109.12.2.1 Road Right-of-Way shall remain clear of construction waste and trash	
109.12.2.2 Waste and Trash Enclosures	Temporary Toilets
109.12.2.3 Loose Construction Debris	Forms and Construction Materials
109.12.2.5 Roofing Tile and Materials	Construction Shacks
Temporary Electric Service Poles	
<b>AND PROTECT ALL GLASS AREAS</b>	